

| | |
|---------------|--|
| Date: | |
| Project Name: | |
| SKU #: | |

Eco EDGE™ LC 130
Wattage & Color Selectable Edgelit Panel

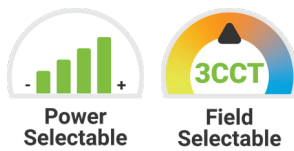

APPLICATIONS

Commercial, Retail, Institution, and Hospitality

FEATURES

Construction

- Aluminum Housing
- PMMA Acrylic Light Guide Plate

Finish

- White Trim

Electrical & Technical

- Input Voltage: 100-277VAC
- Input Frequency: 50/60Hz
- Projected L70 > 50,000 hrs
- PF: >0.9
- CRI: >80 or >90* [Option]
- THD: <20%
- CCT Selectable: 3500K/4000K/5000K
- Field-Adjustable Lumen Output Switch
- Operating Temp.: -4°F ~ 122°F
- Damp Location Rated
- Emergency Battery Backup Driver [Option]
- 15W Emergency Inverter [Option]
- 10W Bodine Inverter [Option]

Optical

- 120° Beam Angle

Installation/Mounting

- Recessed Mounted [Standard]
- Surface Mount Kit
- Flange Mount Kit

Controls

- 0-10V Dimming

Lumen Output

- 1'x4' & 2'x2':
 - 20W (2,500lm)
 - 30W (3,750lm)
 - 40W (5,000lm)
- 2'x4':
 - 30W (3,750lm)
 - 40W (5,000lm)
 - 50W (6,250lm)

Warranty

- 5 Year Warranty
- See warranty documentation for more information.



ORDERING INFORMATION **EXAMPLE: 8822WS-C-L-F**

| Panel | Size | Wattage | CCT | Series | CRI Option |
|-------|--------------------------|------------------|-----------------------|--------|------------|
| 88 | 14 - 1'x4' 22 - 2'x2' | WS - 20W/30W/40W | C - 3500K/4000K/5000K | LF | 90CRI* |
| 88 | 24 - 2'x4' | WS - 30W/40W/50W | | | |

| Surface Mount Kit | Flange Mount Kit | Accessories |
|---|---|--|
| 8814-SK (1x4 Surface Mount Kit) 8822-SK (2x2 Surface Mount Kit) 8824-SK (2x4 Surface Mount Kit) | 8814-FMK (1x4 Flange Mount Kit) 8822-FMK (2x2 Flange Mount Kit) 8824-FMK (2x4 Flange Mount Kit) | 88-WP8-3C (8': 3 Wire Whip [18AWG]) 88-WP8-5C (8': 5 Wire Whip [18AWG]) 90008-L (8W Low Voltage Emergency Battery Backup) T-BR-EM (T-Bar Bracket For Emergency Battery Backup) ELIS10CDF (10W Bodine Inverter) TGS-15W-INT (15W Emergency Inverter) |

DIMENSIONS

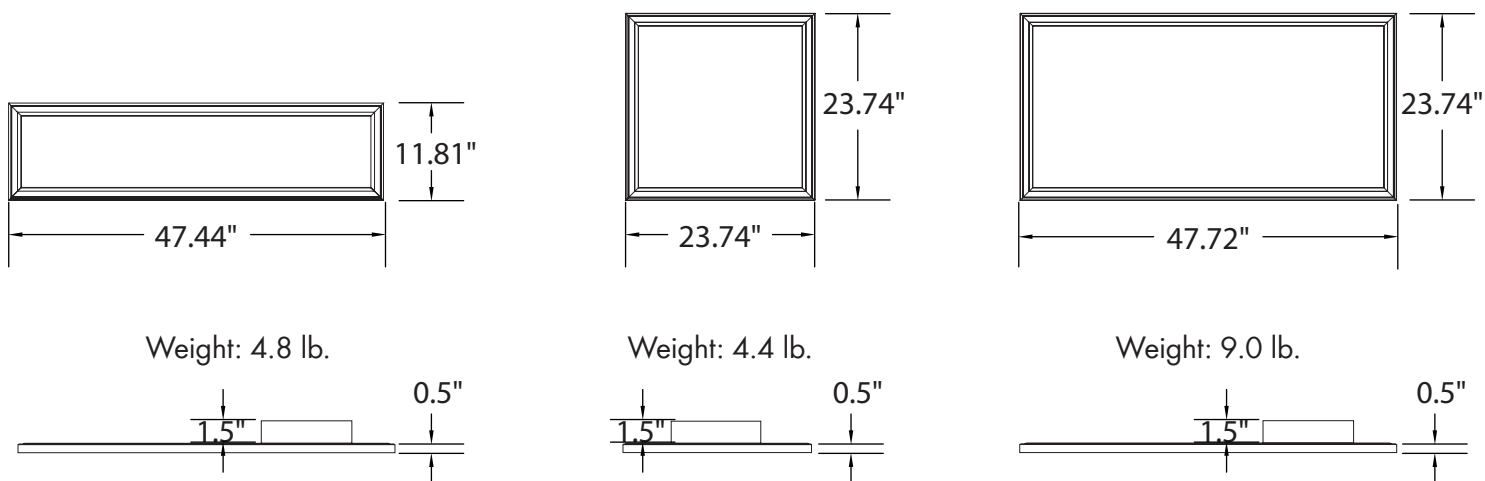

LUMEN OUTPUT

| SKU | Size (LxW) | Wattage (W) | Delivered Lumens (lm) | Efficacy (lm/W) | Delivered Lumens (lm) | Efficacy (lm/W) | Delivered Lumens (lm) | Efficacy (lm/W) |
|-------------|------------|-------------|-----------------------|-----------------|-----------------------|-----------------|-----------------------|-----------------|
| 8814WS-C-LF | 1'x4' | 20/30/40 | 2500 (20W) | 125 | 3750 (30W) | 125 | 5000 (40W) | 125 |
| 8822WS-C-LF | 2'x2' | 20/30/40 | 2500 (20W) | 125 | 3750 (30W) | 125 | 5000 (40W) | 125 |
| 8824WS-C-LF | 2'x4' | 30/40/50 | 3750 (30W) | 125 | 5000 (40W) | 125 | 6250 (50W) | 125 |

ACCESSORIES

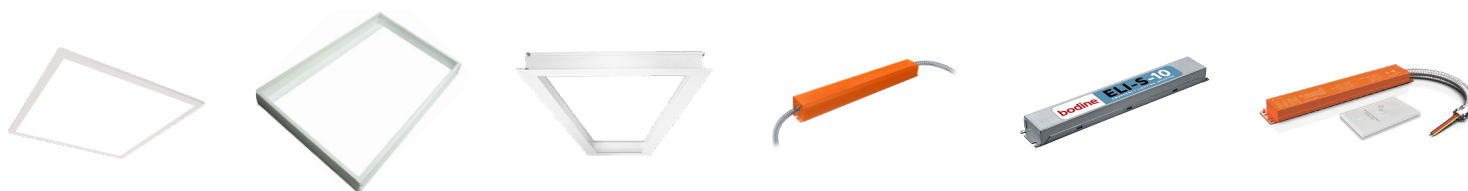

Recessed Mounted Integral Clips [T-Bar] (Standard)

Surface Mount Kit 1'x4', 2'x2', 2'x4' (Option) [8814-SK] [8822-SK] [8824-SK]

Flange Mount Kit 1'x4', 2'x2', 2'x4' (Option) [8814-FMK] [8822-FMK] [8824-FMK]

Low Voltage Emergency Battery Backup (8W) (Option) [90008-L]

Bodine Inverter 10W (Option) [ELIS10CDF]

Emergency Inverter 15W (Option) [TGS-15W-INT]

8' Three Wire Whip or 8' Five Wire Whip (Option) [88-WP8-3C] [88-WP8-5C]

T-Bar Emergency Battery Bracket (Option) [T-BR-EM]