

WARNING

PLEASE READ ALL INSTRUCTIONS BEFORE ATTEMPTING INSTALLATION

- To prevent personal injury or product damage only licensed electricians should install.
- To avoid electric shock or component damage disconnect power before attempting installation or servicing.
- This product must be installed in accordance with the national electric code (NEC) and all applicable federal, state and local electric codes and safety standards.
- Disconnect product and allow cooling prior to servicing.
- Any alteration or modification of this product is expressly forbidden as it may cause serious personal injury, death, property damage and/or product malfunction.
- To prevent wiring damage or abrasion, do not expose wiring to edges of sheet metal or other sharp objects.
- This device is not intended for use with emergency exits.
- This luminaire has been modified to operate LED lamp.
- Suitable for Type IC or Type NON-IC luminaires.
- **CAUTION:** Connect fixture to a 120 Volt, 60Hz power source only. Any other connection void the warranty.

LIST OF RECOMMENDED DIMMERS

LUTRON: DVCL-153PR-WH, CTCL-153PDH-WH, MACL-153MH-WH, P-PKG1W-R

LEVITON: R62-06674-POW, R12-06672-ILW, R50-IPL06-10M

EATON: SAL06P-LA-K

DRRC-0410-CC

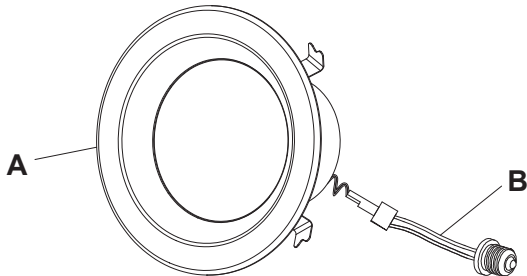

	PARTS	QTY
A	4" Lamp	1
B	E26 socket adaptor	1

DRRC-0614-CC

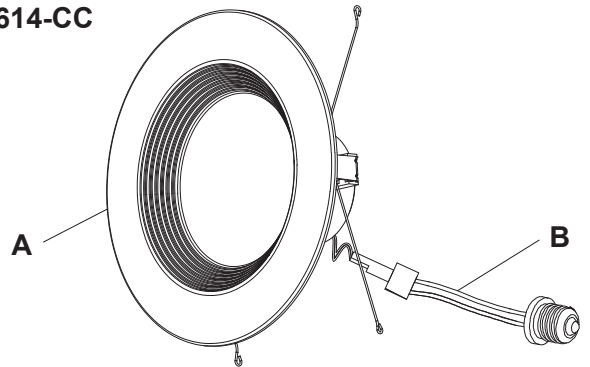

	PARTS	QTY
A	6" Lamp	1
B	E26 socket adaptor	1

Installation

4" Downlight

Fig.1

Remove the recessed can light from existing can housing. Screw in E26 adaptor into socket in the can housing.

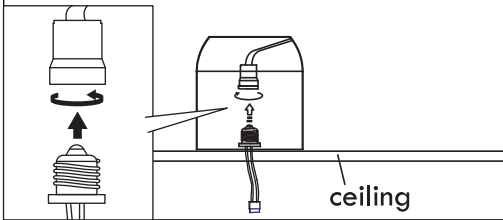

Fig.2

Connect the adaptor cable to the downlight.

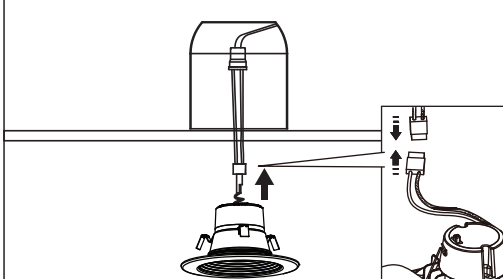
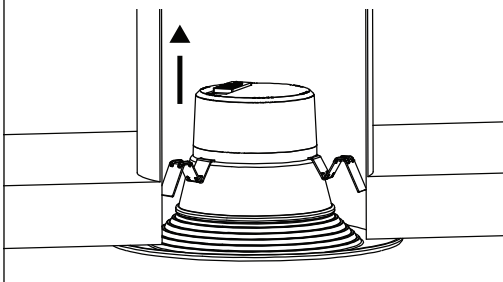

Fig.3

Push the downlight into the can housing ensure it is securely fitted.



6" Downlight

Fig.1

Remove the recessed can light from existing can housing. Screw in E26 adaptor into socket in the can housing.

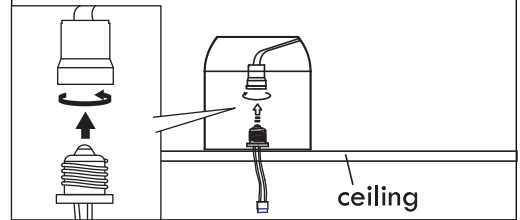

Fig.2

Connect the adaptor cable to the downlight.

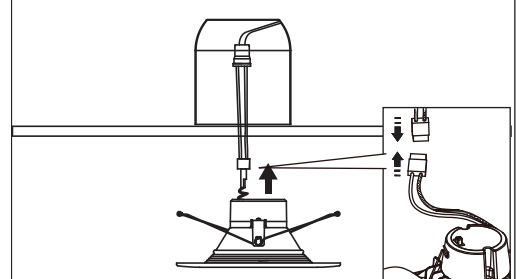

Fig.3

Squeeze the spring clip arms up on both side and hook the clip arms into the arm hook on the inside of the can housing.

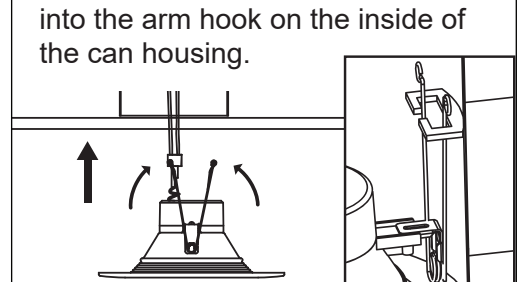

Fig.4

Release the clip arms and push the downlight into the can housing.

