

**WARNING**

**PLEASE READ ALL INSTRUCTIONS BEFORE ATTEMPTING INSTALLATION**

- To prevent personal injury or product damage only licensed electricians should install.
- To avoid electric shock or component damage, disconnect power before attempting installation or servicing.
- This product must be installed in accordance with the national electric code (NEC) and all applicable federal, state and local electric codes and safety standards.
- Disconnect product and allow cooling prior to servicing.
- Any alteration or modification of this product is expressly forbidden as it may cause serious personal injury, death, property damage and/or product malfunction.
- To prevent product malfunction and/or electrical shock this product must be properly grounded.
- This product must be installed in accordance with the applicable installation code by a person familiar with the construction and operation of the product and the hazards involved.
- **RISK OF CUTS:** Some metal parts in the fixture may have sharp edges. To prevent cuts or scrapes, wear gloves when handling parts.
- Properly dispose of packing material and small parts, as these may be hazardous to children.

**Product Specification**

Dimension (DxH)	Wattage	Lumens	Input Voltage	Dimmable
ø6.50x0.78 in.	12W	780 lm	AC120V	No
ø8.94x0.78 in.	18W	1150lm	AC120V	No

**Retrofit Installation**

5/8" Can

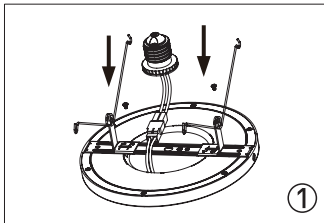

- ① Remove trim and existing lamp from recessed fixture. Press the torsion clip on the bracket and insert into can

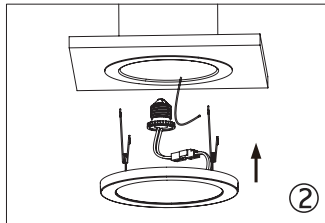

- ② Screw E26 socket adapter into socket in the recessed housing.

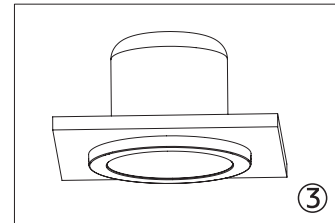

- ③ Press the torsion clip to insert lamp into the recessed housing and restore power.

**Surface Mounting Installation**

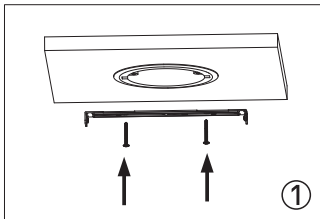

- ① Place bracket on 3" or 4" junction box and secure with screws.

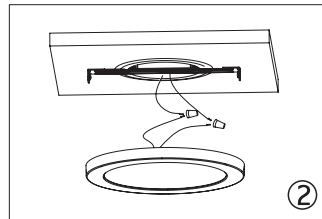

- ② Connect wires.

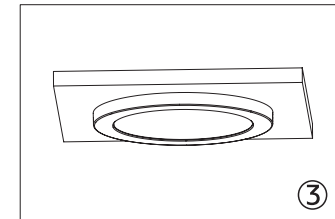

- ③ Place and push lamp on to mounting bracket.

**How to uninstall**



Do not Remove the fixture from anyone side of the self-locking mounting bracket

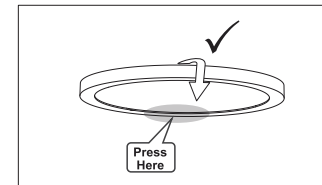
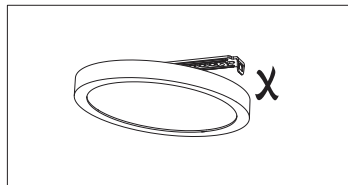

Press one side of the fixture frame (perpendicular to mounting bracket then take out the fixture from the opposite side.

**Caution**

1. WARNING: Risk of fire. Use AC120V 60Hz circuits.
2. Suitable for damp locations. Thoroughly review enclosed installation instructions before installing lighting fixture. A licensed electrician should install product. All electrical connections must be installed in accordance with the national electric code (NEC) and all applicable federal, state and local electric codes and safety standards. Reliable operating temperature is -4~104 degree Fahrenheit.
3. Please obey fire prevention regulation, do not cover the fixture with any heat insulated materials.
4. No serviceable parts.

**Warranty:**

36,000 hours warranty



This product is for indoor use only



For use with dimmers